

* TABLE = 6' x 2.5'

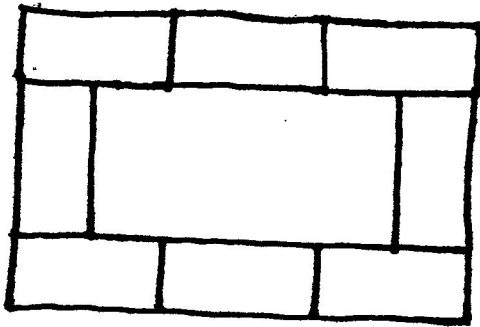

SINGLE TABLE RECTANGLE

- 18' WIDE x 11' DEEP
- 198 SQUARE FEET FOOTPRINT
- 120 SQUARE FEET TABLE SURFACE
- 168 32x32 BASEPLATES *
- CENTER = 72 SQUARE FEET

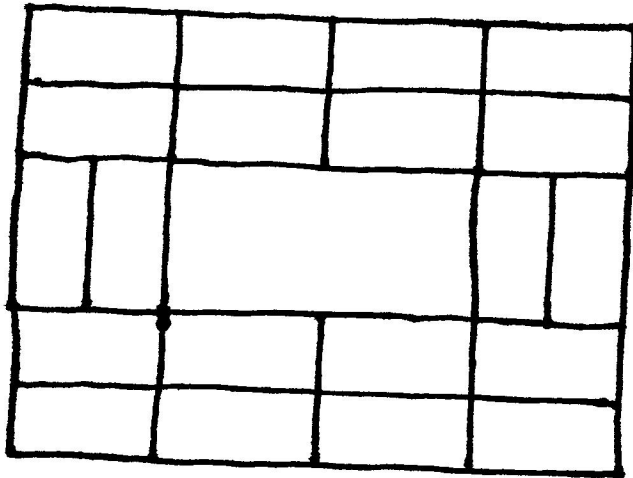

DOUBLE TABLE RECTANGLE

- 18' WIDE x 16' DEEP
- 288 SQUARE FEET FOOTPRINT
- 300 SQUARE FEET TABLE SURFACE
- 420 32x32 BASEPLATES *
- CENTER = 72 SQUARE FEET

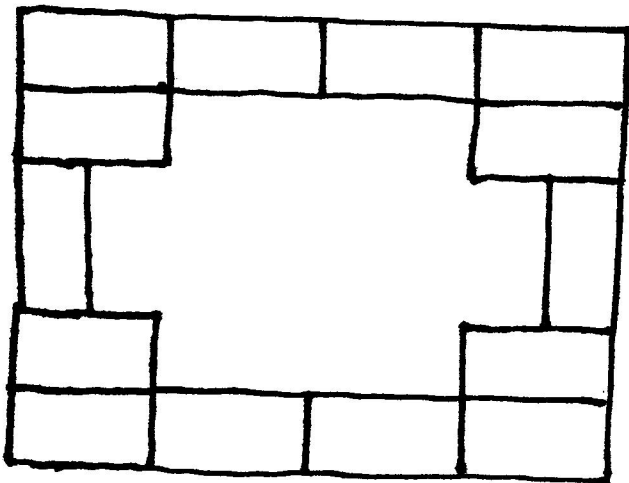

COMB ALTERNATE #1

- 18' WIDE x 16' DEEP
- 288 SQUARE FEET FOOTPRINT
- 210 SQUARE FEET TABLE SURFACE
- 294 32x32 BASEPLATES *
- CENTER = 174 SQUARE FEET

* BASEPLATE COUNTS ARE BASED ON 21 BASEPLATES PER TABLE (30" x 70") - SINCE 6 FOOT TABLES ARE ACTUALLY 72" LONG, ACTUAL BASEPLATE COUNT WILL VARY BASED ON TABLE SET UP - ALSO TRAIN TRACK SPACE MIGHT ALTER / REDUCE BASEPLATE SPACE